



# DATE PALM

BUSINESS PARK AT COACHELLA



**Wesley Ahlgren**

**The Hemmingway Group**

PO Box 13451, Palm Desert California 92255

Cell: 619.890.7178 | Fax: 760.406.4060

wesley.ahlgren@hemmingwaygroup.com



# DATE PALM

BUSINESS PARK AT COACHELLA

HELPING BUSINESSES GROW

THIS IS NOT AN OFFER TO SELL SECURITIES. INFORMATION CONTAINED IN THIS BROCHURE IS NOT AN OFFER TO SELL SECURITIES OR THE SOLICITATION OF AN OFFER TO BUY SECURITIES, NOR SHALL THERE BE ANY SALE OF SECURITIES IN ANY JURISDICTION IN WHICH SUCH OFFER, SOLICITATION OR SALE WOULD BE UNLAWFUL PRIOR TO REGISTRATION OR QUALIFICATION UNDER THE SECURITIES LAWS OF SUCH JURISDICTION.

ALL INFORMATION IN THIS BROCHURE HAS BEEN OBTAINED BY DATE PALM BUSINESS PARK LLC FROM SOURCES BELIEVED TO BE RELIABLE BUT NO REPRESENTATION OR WARRANTY IS MADE AS TO ITS ACCURACY OR COMPLETENESS. NEITHER DATE PALM BUSINESS PARK NOR ANY OF ITS MEMBERS, OFFICERS, EMPLOYEES OR ADVISORS, SHALL BE HELD LIABLE FOR ANY USE OF THE INFORMATION DESCRIBED AND/OR CONTAINED IN THIS BROCHURE.



HELPING BUSINESSES GROW

# SETTING A NEW STANDARD

**Date Palm Business Park** – A new, master-planned business park located just minutes from downtown Coachella, California will set a new standard for healthy, sustainable, community living, and local employment. The proposed project site, currently the location of a date palm orchard, has been completely re-envisioned to incorporate the latest, most innovative, sustainable design standards.

With a total planning area of more than 80 acres, Date Palm Business Park is designed to integrate seamlessly into the City of Coachella's goals for Cannabis Cultivation, Processing, and Manufacturing.

By creating a master plan for the entire project site, Date Palm Business Park will provide backbone infrastructure such as sewer, water, natural gas, hi-speed internet, and provide connectivity that enhances traffic and security circulation for the entire Cannabis Zone.

In addition to the basic infrastructure needs for the area, Date Palm Business Park is setting aside approximately 3.9 acres for an Electrical Substation that will provide the power for this growing area of the City of Coachella.

Date Palm Business Park also features a 6+ acre combined park and retention basin allowing for value engineering of the site and structures.

Furthermore, by combining the total retention/flood protection facilities of the entire 82-acre project site into two large parks, health and safety for the employees is enhanced and maintenance of these facilities is far more efficient.

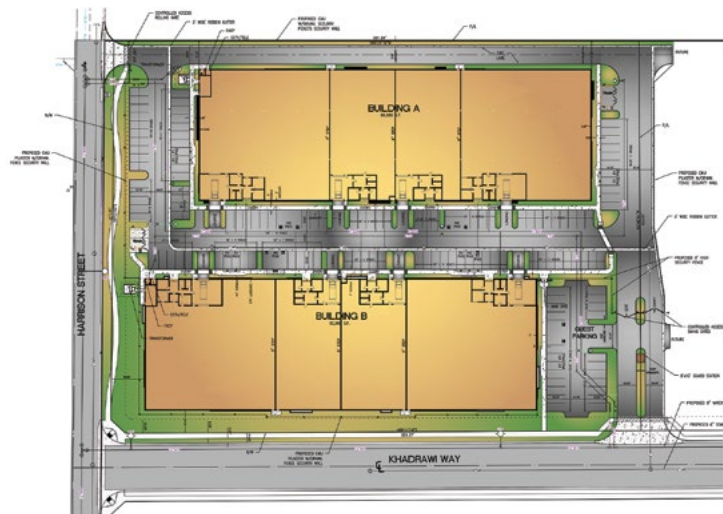

## JUST THE FACTS

- 1,200,000 Square Feet at Build Out
- Approved Tentative Tract Map (TTM 37209)
- Designated Cannabis Zone
- 82 Acres Business Park
- Access to Water
- Access to Power in 2018
- Friendly City Environment
- Long Term Development Agreement
- Competitive Tax & Licensing Structure
- Electric Utility "Will Serve" Letter Approved
- Greenhouse Options Available
- Temporary Use Options Available
- Conditional Use Permit Approved on First 120,000 Square Feet (CUP 290)
- Possible Seller Carry Back

